

1
L2.1 1:750
KEY PLAN

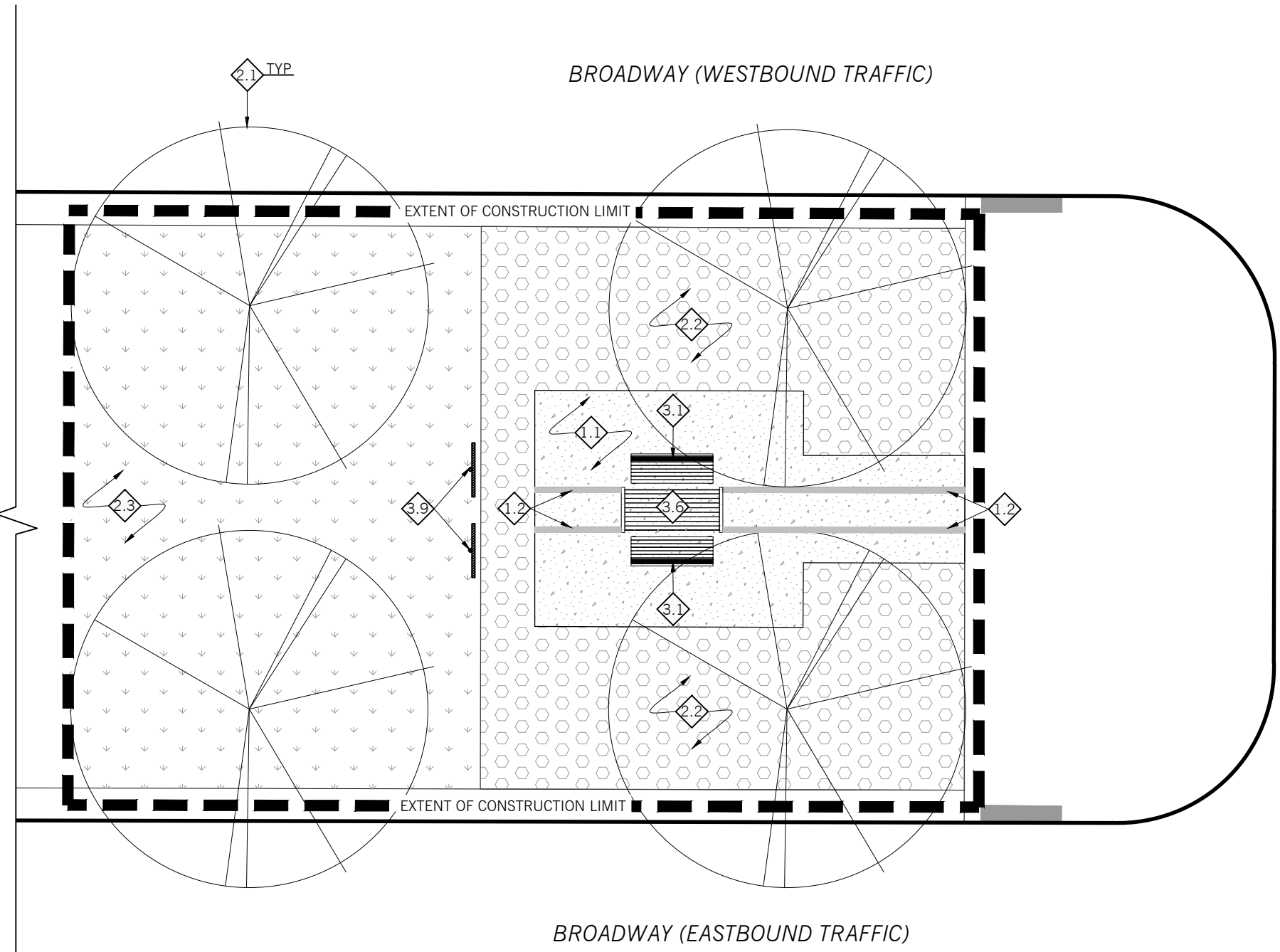

2
L2.1 1:100
NODE 1 - LANDSCAPE SITE PLAN

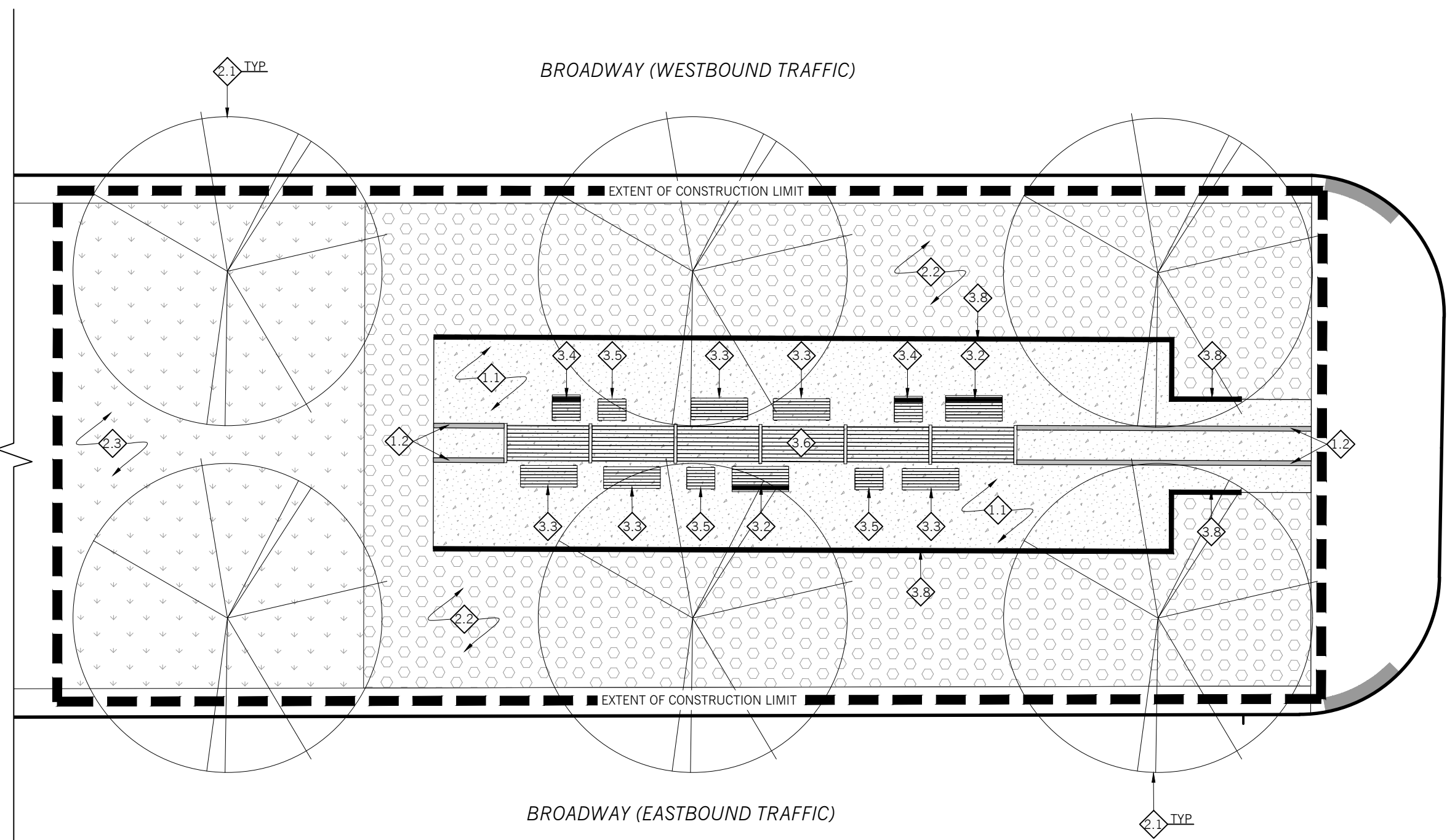

4
L2.1 1:100
NODE 3 - LANDSCAPE SITE PLAN

DRAWING KEYNOTE LEGEND	
	CONSTRUCTION KEYNOTES
HARDSCAPING	
1.1.	C.I.P. CONCRETE SIDEWALK, REFER TO DETAIL 1/L6.1
1.2.	CLAY PAVERS INSET IN C.I.P. CONCRETE SIDEWALK, REFER TO DETAIL 1/L6.1
SOFTSCAPING	
2.1.	TREES SHOWN FOR INFORMATION, THEY WILL BE SUPPLIED AND INSTALLED BY THE CITY OF WINNIPEG (N.I.C.)
2.2.	PLANTING BED C/W ALUMINUM EDGING WHERE ADJACENT TO SOD, REFER TO DETAIL 2/L6.1
2.3.	SODDING, REFER TO CITY OF WINNIPEG SPECIFICATION CW 3510 - R10
SITE FURNISHING & PRE-MANUFACTURED ITEMS	
3.1.	MANUFACTURED 1525mm (5FT) BACKED BENCH, REFER TO SPECIFICATIONS
3.2.	MANUFACTURED 1220mm (4FT) BACKED BENCH, REFER TO SPECIFICATIONS
3.3.	MANUFACTURED 1220mm (4FT) BACKLESS BENCH, REFER TO SPECIFICATIONS
3.4.	MANUFACTURED 610mm (2FT) BACKED CHAIR, REFER TO SPECIFICATIONS
3.5.	MANUFACTURED 610mm (2FT) BACKLESS CHAIR, REFER TO SPECIFICATIONS
3.6.	MANUFACTURED TABLE, REFER TO SPECIFICATIONS
3.7.	MANUFACTURED WASTE RECEPTACLE, REFER TO SPECIFICATIONS
3.8.	STEEL EDGE RETAINING WALL, REFER TO DRAWING L3.1 AND DETAILS 4 AND 5/L6.1
3.9.	PROVINCIAL HERITAGE SIGNAGE C/W FOOTING, REFER TO DETAIL 3/L6.1

DRAWING PATTERNS	
	C.I.P. CONCRETE PAVEMENT
	INSET CLAY PAVERS
	PLANTING BED C/W SHREDDED WOOD MULCH
	SODDING

CITY OF WINNIPEG FULL-PROFILE SOIL REPLACEMENT APPROACH	
1.	REFER TO DRAWING L1.1 FOR SOIL EXCAVATION NOTES.
2.	BACKFILL WITH A SOIL BLEND COMPLIANT WITH CW 3540, SECTION 5.2, AMENDED WITH COMPOST AT A 1:2 RATIO (APPROX. 33% BY VOLUME). THE FINAL MIX SHOULD NOT EXCEED 10% TOTAL ORGANIC MATTER CONTENT BY ANALYSIS.
3.	AVOID MECHANICAL COMPACTION OF BACKFILL; USE LOW-GROUND-PRESSURE EQUIPMENT SO THAT PROCTOR DENSITY DOES NOT EXCEED 75%.
4.	DO NOT TILL COMPOST INTO EXISTING SOIL - FULLY REMOVE AND REPLACE THE EXISTING SOIL AND REPLACE THE PROFILE AS DESCRIBED ABOVE.
5.	APPLY 50-100 MM DEPTH OF COARSE MULCH (E.G. WOOD CHIPS) OVER ALL PLANTING ZONES AFTER SOIL PLACEMENT.
6.	CLEARLY MARK AND FENCE OFF REMEDIATED ZONES TO PROTECT THEM FROM CONSTRUCTION TRAFFIC IMMEDIATELY FOLLOWING SOIL PLACEMENT.

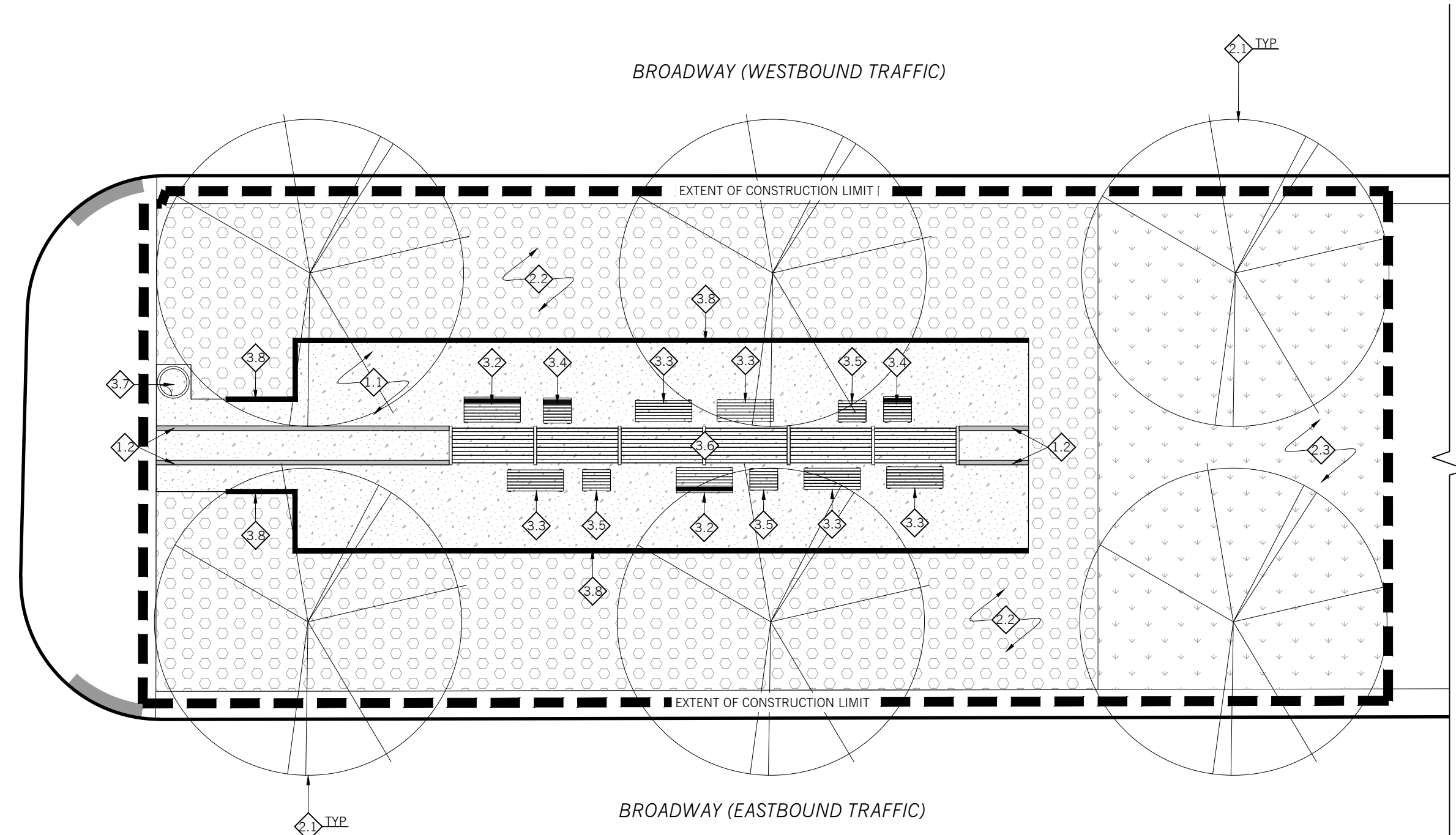

3
L2.1 1:100
NODE 2 - LANDSCAPE SITE PLAN

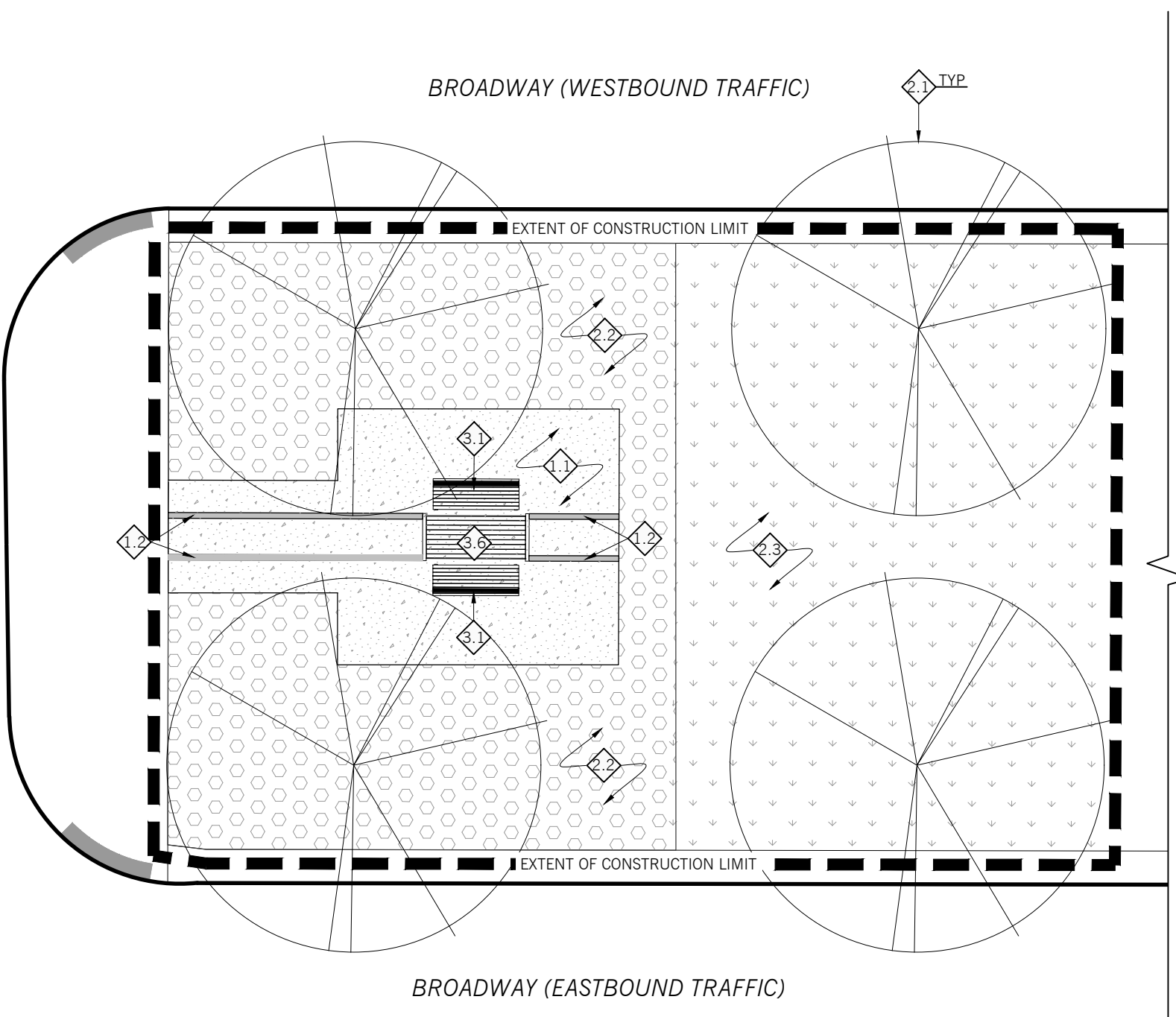

5
L2.1 1:100
NODE 4 - LANDSCAPE SITE PLAN

Drawings and specifications, as instruments of service are the property of the architect, the copyright in the same being reserved to him. No reproduction may be made without the permission of the architect and when made, must bear his name. All prints to be returned to the architect. The contractor shall verify dimensions and data noted herein with conditions on the site and is held responsible for reporting any discrepancy to the architect for adjustment. This drawing shall not be used for building purposes until countersigned by:

SUBCONSULTANTS

PROFESSIONAL'S SEAL



1	2025 / 08 / 18	ISSUED FOR CONSTRUCTION	CA	
ISS./REV	YY / MM / DD	DESCRIPTION	BY	



CONSULTANT FILE NAME
24810 BROADWAY SEATING NODES

CLIENT

CITY OF WINNIPEG
PLANNING & URBAN DESIGN DIVISION
PLANNING, PROPERTY & DEVELOPMENT DEPARTMENT



BROADWAY SEATING NODES

BD OPPORTUNITY No.
748-2025

SHEET
2 OF 6

LANDSCAPE SITE PLANS

DESIGN KS/BS	DRAWING KS/BS	DATE - Y / M / D 25 / 08 / 18
CHECKED CA	APPROVED CA	PROJECT No. 24.810

L2.1